

**Subject:** Information re:Yarrabah Public Forum and Hearing response

**From:** Vincent Mundraby [REDACTED]  
**Sent:** Monday, 23 June 2014 11:00 AM  
**To:** Agriculture Resources and Environment Committee  
**Cc:** Curtis Pitt  
**Subject:** information re:Yarrabah Public Forum and Hearing response

Attention: Mr Ian Rickuss MP

Please find attached information as discussed as per our discussions at the Yarrabah Public Forum and Hearing held at Yarrabah Wednesday 18 June 2014 between 2.00PM-4.00pm

As presented the attachments relate to submission made to the Government back in the early to mid-70's regarding commercial leasing in Yarrabah however the Government of the day refused to sign off due to the Deed of Grant in Trust being issued in 1986

To date the Block has been involved in cultural site clearance through due process's and is situated in the township area of the Yarrabah Shire

It is blocks with similar occupation and invitations from the government of the day as discussed there is a number in this situations who should be afforded the opportunity to be issued Freehold Title

#### **Natural Justice**

It is with great anticipation that natural justice be granted due to the long association with the land and the due process established accumulating in the Lease documents being issued however the government failing to certify/confirm and or sign off on the proposed leasing arrangements way back in the mid 70's

In doing so I now call on the State Government to do the right thing and consult with the Lease holders as identified in the above attachments with a view of Free Holding the said lands and give closure to the aspirations of the Yarrabah Share Farmers/Block Holders instigated by the Government of the day way back in 1970-75

I look forward to your favourable reply

Cheers  
Vince Mundraby

Vincent MUNDRABY

Top Paddock : 3.51 ha  
Bottom Paddock : 6.89 ha  
TOTAL FARM AREA : 10.40 ha (25.70  
Area Bananas : 1.64 ha (4 acr

Scale - 1:2 000

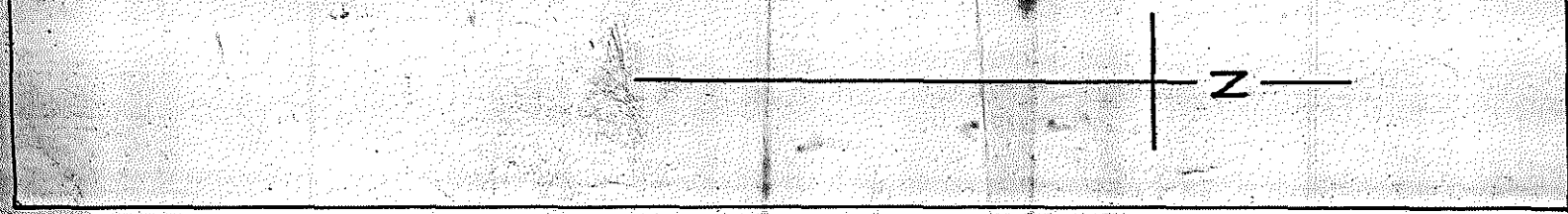
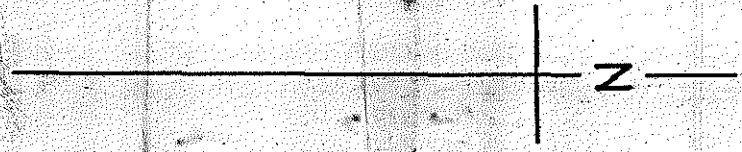
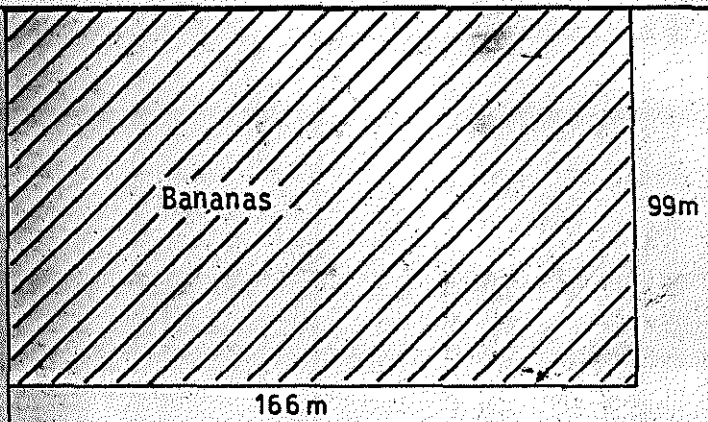
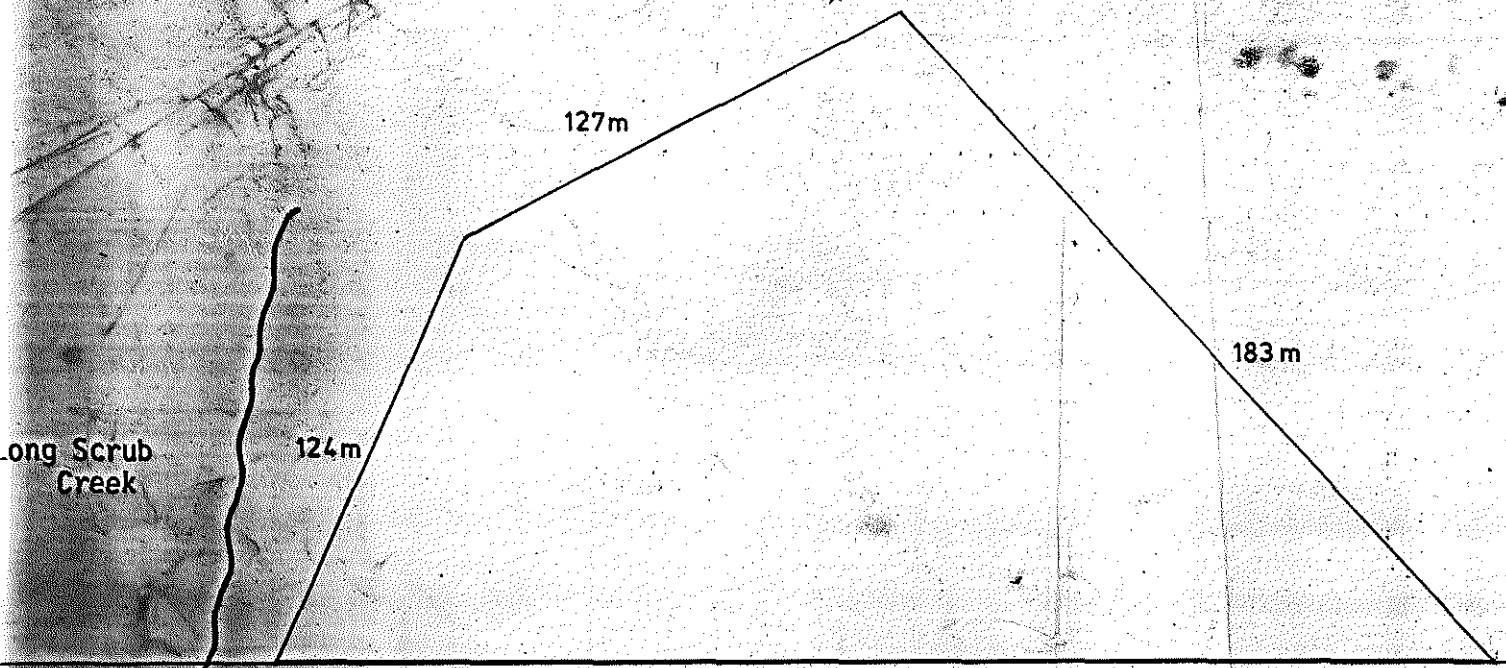

164 m

420 m





 Area of Interest - Abt

Boundaries of Blockholder interests are indicative only.

Map created by: Geospatial Services,  
National Native Title Tribunal (16/06/2010)

Cyclone Larry imagery supplied under  
Multi User License from Geoscience Australia.

Map Ref: 20100616\_Vincent\_A4L.pdf

Copyright © Commonwealth of Australia

The Registrar, the National Native Title Tribunal and its staff, members and agents and the Commonwealth (collectively the Commonwealth) accept no liability and give no undertakings guarantees or warranties concerning the accuracy, completeness or fitness for purpose of the information provided. In return for you receiving this information you agree to release and indemnify the Commonwealth and third party data suppliers in respect of all claims, expenses, losses, damages and costs arising directly or indirectly from your use of the information and the use of the information you obtained by any third party.

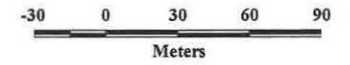

Latitude and Longitude based on Geocentric Datum of Australia 1994  
Non Projection



Location Diagram

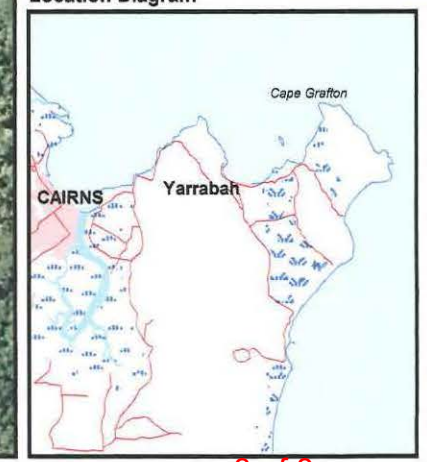



Vincent MUNDRABY

Top Paddock : 3.51 ha  
Bottom Paddock : 6.89 ha  
TOTAL FARM AREA : 10.40 ha  
Area Bananas : 1.64 ha

Scale - 1:2 000

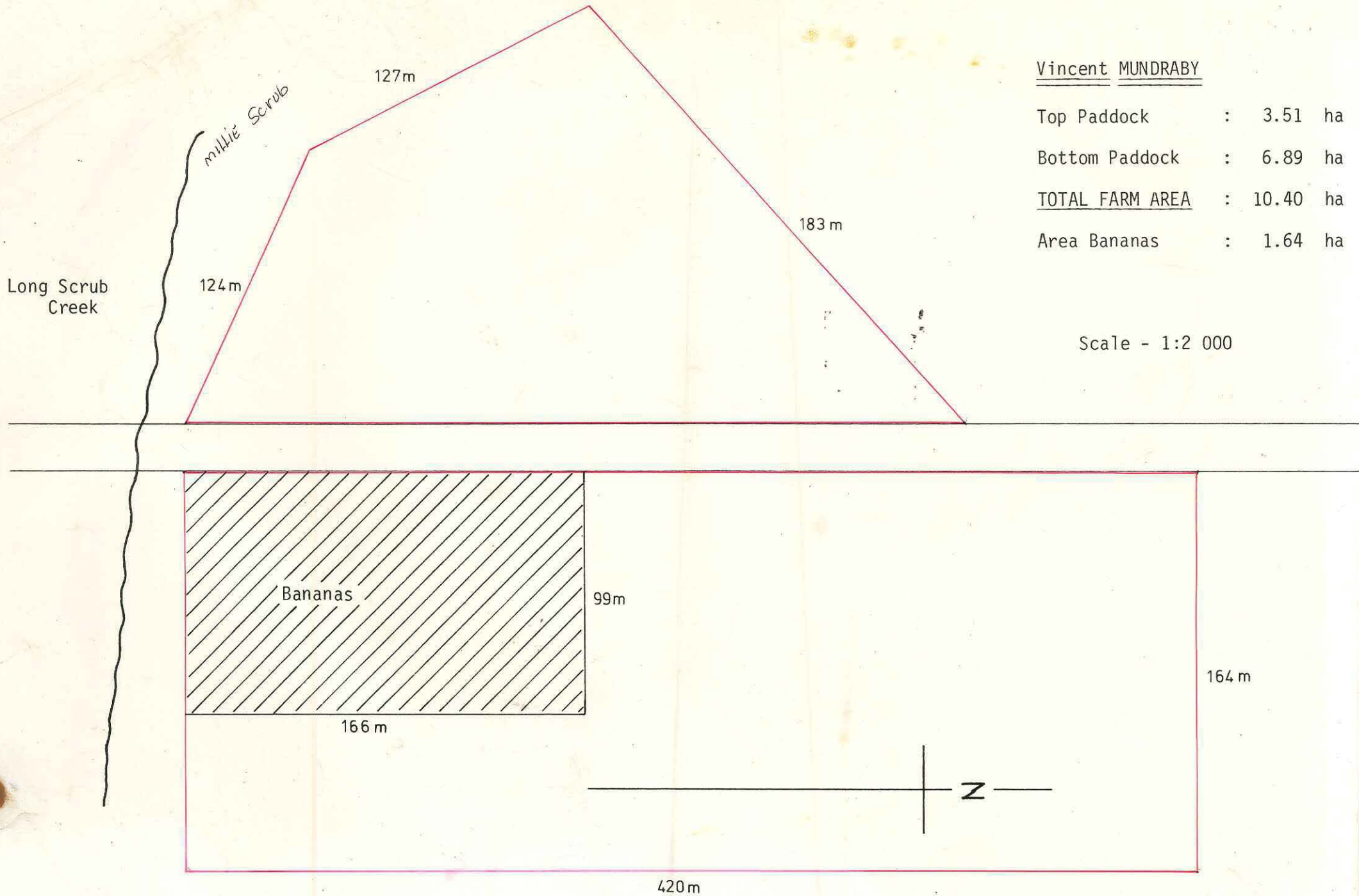

# YARRABAH COMMUNITY COUNCIL

Sub # 9

TELEPHONE (070) 569128

IN REPLY PLEASE QUOTE

POSTAL ADDRESS:  
c/- POST OFFICE  
YARRABAH  
Q. 4871

L/43:AEC:PMC.

3rd August, 1984.

Mr. V.B. Mundraby,  
c/- Post Office,  
YARRABAH. 4871.

CIRCULAR.

Dear Sir,

Re: Land Application.

I refer to your application for a lease of land at Yarrabah.

At its meeting of 31st July, 1984, Council resolved that the following conditions should apply to future land leases at Yarrabah.

1. Housing blocks to be one quarter acre.  
(20 metre frontage x 40 metre deep).
2. Farm blocks to be 15 acres.
3. Clearance either side of creeks or streams to be 20 metres.
4. A minimum of 5 acres be cultivated on farming blocks within first 12 months.
5. Rentals to be \$2-00 per week, subject to review at a later date, payable quarterly.
6. Toilet and garbage facilities to be established by lessees before taking up residence ( plan of toilet to be supplied).
7. Rates to be payable at a rate to be fixed at a later date.
8. Land the subject of a lease will revert to Trustees (Council) should lessee cease to become a resident of Yarrabah.

You should now commence to peg out the block you have applied for so the Council may inspect the site and reach agreement with you on which of the above conditions are applicable to your block.

Yours faithfully,

*K.A. Gray*  
K.A. GRAY,  
CHAIRMAN,  
COMMUNITY COUNCIL,  
YARRABAH.

5 of 8





TELEPHONES:

DIRECTOR 229 3113  
GENERAL OFFICE 224 0515

EXT.....5721

TELEGRAPHIC ADDRESS:  
"ABORIGINES," BRISBANE

In further reference please quote—

15E/11 15A/215

DEPARTMENT OF ABORIGINAL  
AND ISLANDERS ADVANCEMENT,

135-147 GEORGE STREET,  
BRISBANE, Q. 4000

P.O. Box 133,  
North Quay, 4000

21st March, 1980

Mr. V. Mundraby  
Back Beach Road,  
YARRABAH

Dear Mr. Mundraby,

The Manager, Yarrabah has forwarded your application for lease of an area presently being farmed by you at Yarrabah.

Your application is receiving consideration and further advice will be furnished to you in due course.

Yours faithfully,

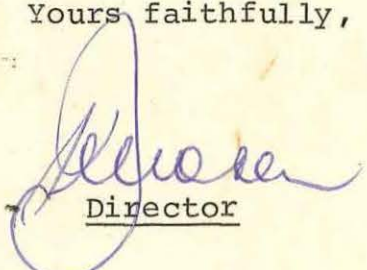
  
Director

Mr V.B. Mundraby,  
Noble Drive,  
YARRABAH, Q. 4871

14th March 1984.

The Hon. R. Katter, M.L.A.,  
Minister for Northern Development  
and Aboriginal and Islanders  
Advancement,  
Parliament House,  
BRISBANE, QLD. 4000

Dear Mr Minister,

Re: Farm - Yarrabah

I have noticed that certain businesses are being given to residents of Yarrabah or so I have been told.

If this is so, I would like to apply to have the Departmental Farm handed over to me. I am writing to you because I believe the Council would not give it to me as they will want it for one of them.

I am at present employed by the DAIA as the Assistant Farm Overseer and have been solely responsible for the running of the Farm for the last 4½ years as we have never had a Farm Overseer in that time.

I am an Aboriginal and am a Yarrabah resident so the Council could have no objection to this other than they would want it for one of them or their family.

I know the difficulties of running a Farm as I have been a Share Farmer here before and have discussed this matter fully with the Manager Mr Harris and understand why the farms have not been economical in the past and what needs to be done.

I also know I would require a lot of support initially from him and the Department but believe I am better equipped than anyone else here, to make a go of it.

Would you please give this request your favourable consideration and I believe Mr Harris would support my application.

Yours faithfully,

B/C:

The Director,  
D.A.I.A.,  
BRISBANE, Q. 4000

V.B. MUNDRABY

For your information.

V.B. MUNDRABY....14/3/84



VINCENT MUNDRASY.

Sub # 9



146  
St. 28407  
Coff. No. 4208  
151  
O. 203  
No. 4580  
Kinnabur Beach  
Yarrabah Mission Station  
147  
R. 1171  
Hospital  
149  
Coff. No. 4208  
165 R. 1296  
Dept. Land Imp. Co.  
No. 4208

R.204

VINCENT SCHRIEBER, 237 HA.

RAY PRIOR

MURRAY

Aboriginal Settlement

MT. GORTON  
2654

2 VINCENT MUNDRASY 10.40 HA

3 WAYNE CONNOLLY 8.59 HA

Reserve for the benefit of Aborigines

4 PETER KYLE 6.57 HA

5 ALLAN RYNUNA 2.74 HA

MAY PEAK

Oomburgha