

Gary & Evelien Parker

BEAUDESERT QLD 4285

Research Director
Agriculture and Environment Committee
Parliament House
BRISBANE QLD 4000

24th April 2016

To whom it may concern:

Re: Strongly oppose the Proposed Vegetation Management Bill

When we purchased our land in the early 80's it was part of a high value grazing property. We have continued to use the land for this purpose for over 35 years. We have planted forest trees and native trees for wind brakes and privacy and future timber to be used on the property. Any trees we have removed have been replaced tenfold by these plantings. This paddock has been used as a fattening paddock for beef cattle in conjunction with another family property nearby and we have gone to great effort and expense to maintain this property in a productive capacity.

With the stroke of a pen the rezoning proposed in the new regrowth legislation has coveted approximately 50% of our land and 100% of the land on which our home is built and the area where most of the tree planting was undertaken and where the highest value agricultural soil is located. We feel that there is a high degree of inaccuracy in determining the area marked on the proposed map (5.3 and 5.4) by the stroke of said pen. It would also appear that our property (and I would suggest many others) is being used as a scape goat for misdemeanours committed by developers in surrounding and other far away areas (ie: NQ) and the misguided political and personal agenda of certain well-meaning people in the community. If these areas are left to regrowth and unchecked the dominant species like lantana and other imported weeds will smother the native vegetation and create an impenetrable barrier, blocking any maintenance on the affected area, and creating high fuel loads and thus high bush fire danger.

As a past long term member of the local rural fire brigade I have experienced the frustration of not being able to access overgrown areas to protect local houses, property and people. It appears that wherever development and conservation areas clash neglect allows these areas to become overgrown and create this problem, especially "lantana" which is an imported species and not a native plant as it seems it is being promoted.

I personally do not want the responsibility of the danger created by these regrowth corridors on my property propagating fire risk to my neighbours and surrounding properties. I believe a simple forestry management plan would suffice to adequately and responsibly manage my property.

We have had no contact or consultation about the mapped area that has been scratched on our property. It was only through word of mouth that this came to my attention. If this legislation is approved in its proposed form it will infringe on our rights as freehold landowners, it will devalue our property, severely restrict the agricultural activities we carry out and affect our children's and grandchildren's future if they wish to continue on with the use of the land.

We have had no consultation with reference to compensation for the effects of the proposed legislation. We are not anti-conservation but we are extremely disappointed in the deceptive way this legislation has been presented. We sincerely hope that common sense prevails and this legislation is not passed in its present form.

Yours Sincerely,



Gary Parker



Evelien Parker

5.3 Proposed regulated vegetation management map

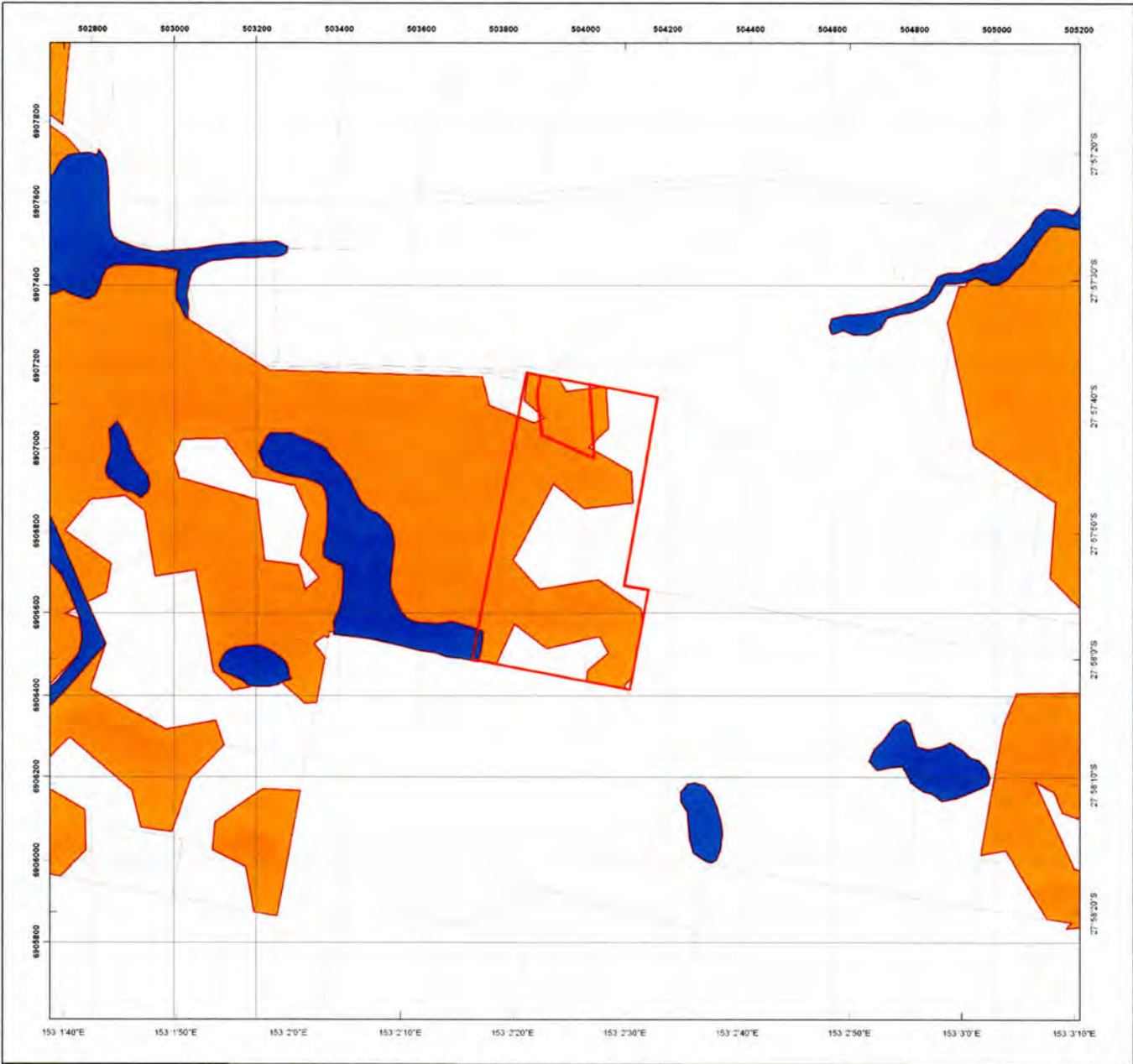

Proposed Regulated Vegetation Management Map

Please note, the Government has proposed changes to the Category C and Category R areas which are shown on this map. For more information on these changes, please refer to the Department's website.

Legend

- Lot and Plan
- Category A area (Vegetation offsets/compliance notices/VDecs)
- Category B area (Remnant vegetation)
- Category C area (High-value regrowth vegetation)
- Category R area (Reef regrowth watercourse vegetation)
- Category X area (Vegetation not regulated under the VMA)
- Proposed category C area
- Proposed category R area
- Water
- Area not categorised
- Cadastral line
- Property boundaries shown are provided as a locational aid only

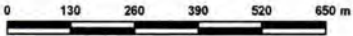
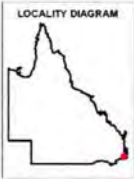

Disclaimer:
While every care is taken to ensure the accuracy of this product, the Department of Natural Resources and Mines makes no representations or warranties about its accuracy, reliability, completeness or suitability for any particular purpose and disclaims all responsibility and all liability (including without limitation, liability in negligence) for all expenses, losses, damages (including indirect or consequential damage) and costs which you might incur as a result of the product being inaccurate or incomplete in any way and for any reason.

Additional information required for the assessment of vegetation values is provided in the accompanying "Proposed Vegetation Management Supporting map". For further information go to the web site: www.dnrm.qld.gov.au or contact the Department of Natural Resources and Mines.

Digital data for the regulated vegetation management map is available from the Queensland Spatial Portal at <http://www.information.qld.gov.au/>

This map is updated on a monthly basis to ensure new PMAVs are included as they are approved.



This product is projected into:
GDA 1994 MGA Zone 56

5.4 Proposed vegetation management supporting map

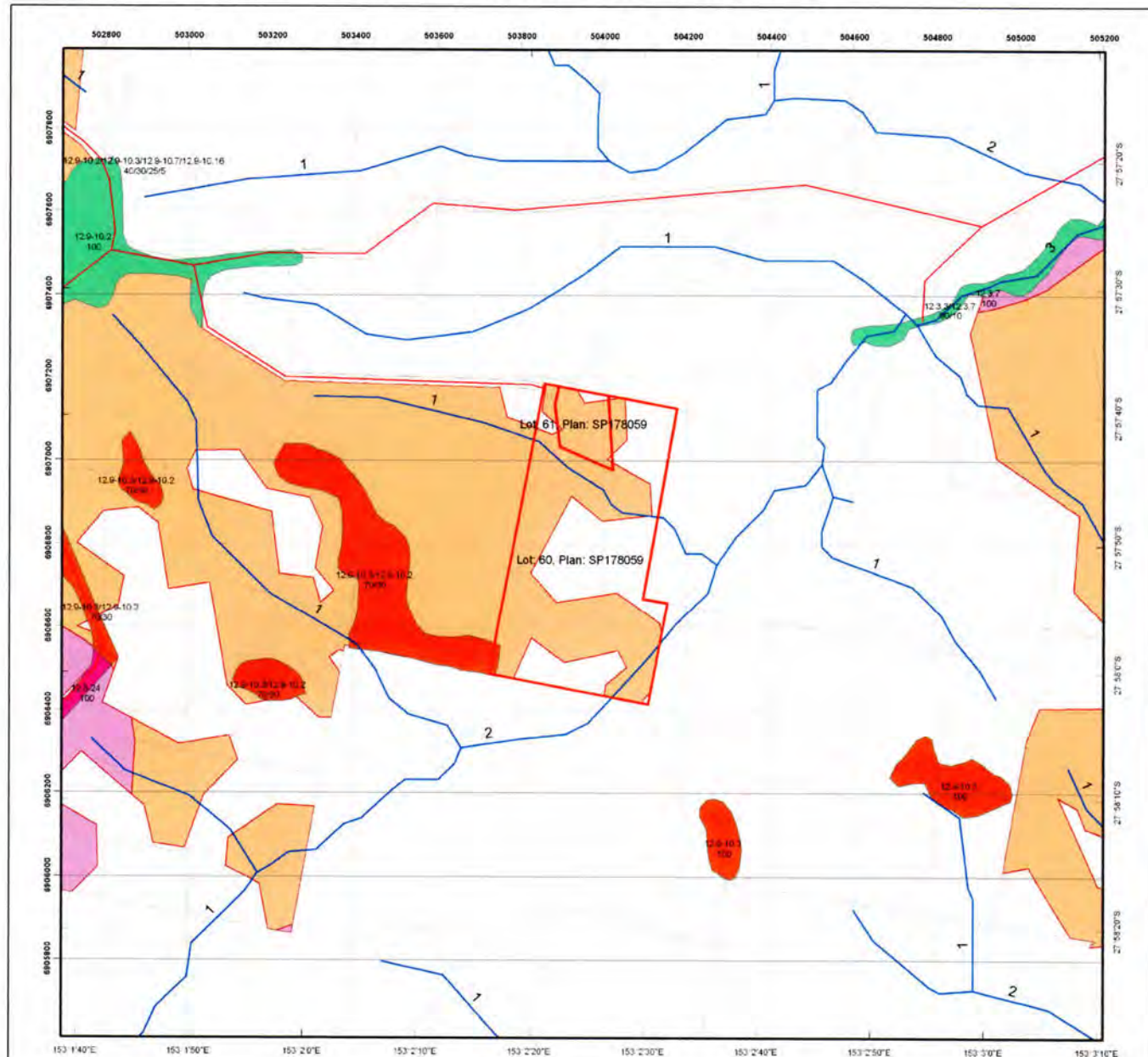

Proposed Vegetation Management Supporting Map

Legend

- Lot and Plan
- Category A or B area containing endangered regional ecosystems
- Category A or B area containing of concern regional ecosystems
- Category A or B area that is a least concern regional ecosystem
- Category A or B area containing remnant vegetation
- Category A or B area under Section 20AH
These areas are edged in yellow and filled with the remnant RE Status
- Category C and proposed category C area containing endangered regional ecosystems
- Category C and proposed category C area containing of concern regional ecosystems
- Category C and proposed category C area that is a least concern regional ecosystem
- Category C and proposed category C area containing high value regrowth vegetation
- Category C area under Section 20A1
These areas are edged in purple and filled with the remnant RE Status
- Non Remnant
- Water
- Wetland on the vegetation management wetlands map
- Essential habitat on the essential habitat map
- Essential habitat species record
- ~ Watercourse on the vegetation management watercourse and drainage feature map
(Stream order shown as black number against stream where available)
- ~ Roads
- National Parks, State Forest and other reserves
- Cadastral line
- Property boundaries shown are provided as a locational aid only



0 100 200 300 400 500 m

This product is projected into:
GDA 1994 MGA Zone 56

Labels for Essential Habitat are centred on the area of enquiry.

Regional ecosystem line work has been compiled at a scale of 1:100 000, except in designated areas where a compilation scale of 1:50 000 is available. Linework should be used as a guide only. The positional accuracy of RE data mapped at a scale of 1:100 000 is +/- 100 metres.

Disclaimer:

While every care is taken to ensure the accuracy of this product, the Department of Natural Resources and Mines makes no representations or warranties about its accuracy, reliability, completeness or suitability for any particular purpose and disclaims all responsibility and all liability (including without limitation, liability in negligence) for all expenses, losses, damages (including indirect or consequential damage) and costs which you might incur as a result of the product being inaccurate or incomplete in any way and for any reason.

Additional information may be required for the purposes of land clearing or assessment of a regional ecosystem map or PMAV applications. For further information go to the web site: www.dnrm.qld.gov.au or contact the Department of Natural Resources and Mines.

Digital data for the vegetation management watercourse and drainage feature map, vegetation management wetlands map, essential habitat map and the vegetation management remnant and regional ecosystem map are available from the Queensland Spatial Portal at <http://www.information.qld.gov.au/>

